

Alrewas Quarry Update



Aerial image of Alrewas Quarry

About Tarmac

Tarmac is the UK's leading supplier of construction materials. With over 150 years of experience and heritage to our name, we're a national network of local businesses. We provide vital building materials, such as stone, sand, gravel, concrete, asphalt and mortar, that enable the construction and maintenance of homes, roads and key national infrastructure, which play a vital part in our everyday lives. We employ around 7,000 people across a network of more than 350 sites in the UK.

Alrewas Quarry

Alrewas Quarry is a sand and gravel quarry located to the east of the A38 in Alrewas, Staffordshire. Sand and gravel have been extracted at Alrewas since the 1970s, and the site covers approximately 250 hectares, some of which has been restored, some of which is being worked, and the remainder of which as yet remains undisturbed. The minerals extracted have been used for both local and national construction projects, including as a component to construct the diving boards at the 2012 Olympic Games.

The sand and gravel deposits are extracted in a phased manner, and transported by a combination of dump truck and field conveyor to an on-site processing plant.

Restoration at Alrewas

The restoration schemes at Alrewas are mainly based on importing inert materials (e.g. excavation arisings with clay and soil) to develop the restoration landforms. As shown on the image above, to date we have restored previous extraction areas to:

- High-quality arable farmland
- Ecological wetlands
- Private leisure lakes (at Whitemoor Haye)
- National Memorial Arboretum (NMA)

We anticipate that we will complete the restoration landform in Phase 1 later this year/early next year, which among other things will enable the construction of a new and permanent car park for the NMA.

Did you know?

The restoration of our sites gives us the opportunity to create an improved and more diverse environment, as well as improving biodiversity and providing amenities for residents. So far, at Alrewas we have restored just under 290 hectares – that's the equivalent of 406 football pitches!

Future plans



Example of a dredging operation (Crown Farm)

The sand and gravel reserves east of the A38 at Alrewas Quarry are due to come to an end by the late 2020s. We have therefore started reviewing our options to ensure that there remains a continuous supply of sand and gravel in the county.

Staffordshire County Council's Minerals Local Plan (2015-2030) identified an Area of Search to the west of the A38. This means that any proposals for extraction in the Area of Search will only be supported by the council if the sand and gravel reserves east of the A38 are exhausted, and if certain other tests and conditions defined in the Minerals Local Plan are met.

We have identified a site within the Area of Search and are at the very early stages of preparing a planning application. This proposed new quarry would replace Cemex's existing sand and gravel operations at Pyford Brook Quarry. It is located off the A513 and to the west of the A38.

The current Cemex site covers an area of around 32 hectares, whereas the proposed scheme we are currently developing covers an area of 138 hectares. Not all of this will be subject to extraction.

Most extraction would be undertaken using a dredger (see image) meaning that the mineral is extracted underwater and pumped to the processing site – reducing the visual impact, as well as the potential for noise and dust.

We have recently submitted a scoping request to Staffordshire County Council to establish what environmental assessments we will need to undertake as part of our planning application. We have had some very early conversations with the parish councils and councillors, and will run a full public consultation later in the autumn, once we have sufficient information following the investigations and studies that we need to complete.

Did you know?

The sand and gravel deposits in the vicinity of Alrewas have been in the making for over 200 million years, with a process of glacial and river erosion leading to the presence of large tracts of sand and gravel along the county's river systems, including the Trent and the Tame.

Proposed working and restoration scheme

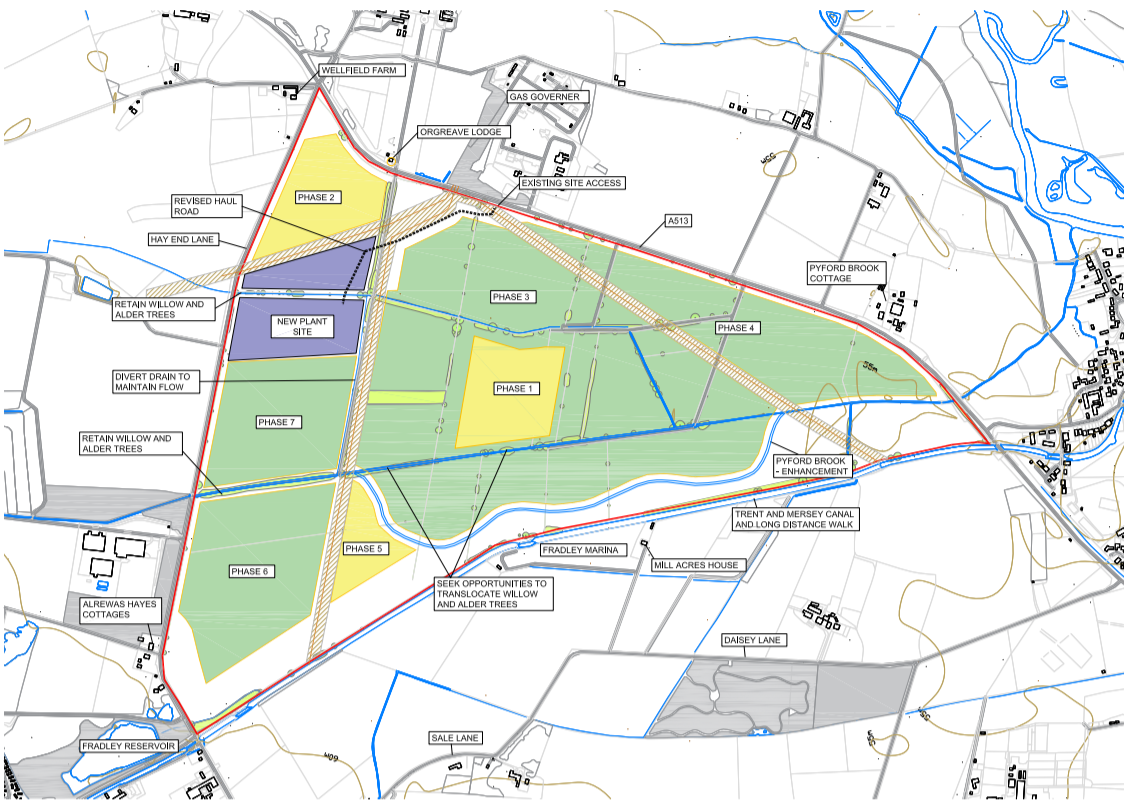

Working scheme

Working scheme

The proposed site benefits from well-defined boundaries, including the A513 to the north and east, Hay End Lane to the west, and the Trent and Mersey Canal to the south.

The proposed quarry would be extracted in phases to minimise the amount of land in operation at any one time and enable us to bring forward restoration benefits as early as possible. We would propose to use the existing access on the A513, but will commit to no lorries travelling through the villages of Alrewas or King's Bromley (except for infrequent local deliveries).

We would also ensure that the processing plant and associated infrastructure, such as the ready-mixed concrete plant, would be subject to a comprehensive review to ensure that it is as far as possible in keeping with the local landscape setting.

Restoration scheme

We are proposing to restore the site to a series of large-scale open-water bodies, and would welcome your views on what form this might take so that we can create a valued local amenity. As well as water bodies, we are proposing to return areas of land to agricultural use and establish a range of nature conservation habitats that are consistent with the local area.

The delivery of this restoration scheme would not require the importation of any materials, meaning that the restoration should not be subject to delays. As part of our proposals, biodiversity net gain would be delivered on site, and we would work with local ecological groups to deliver this.

We would also build on commitments by Cemex and look to divert and enhance Pyford Brook by creating an undulating watercourse that supports the local ecology to thrive.

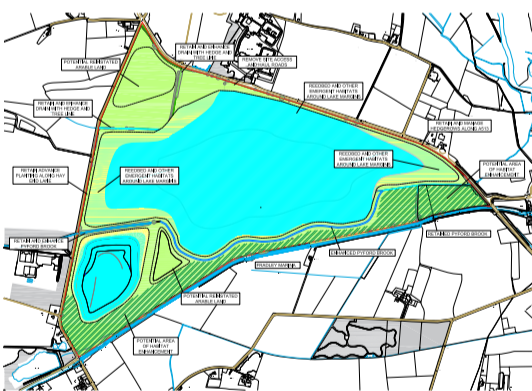

Restoration plan with no mains

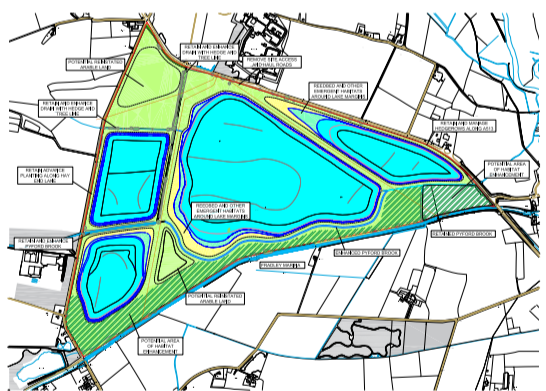

Restoration plan with mains

Supporting the community



Community project support - Cricket Club

It is important to us that we are a good neighbour to those living and working close to our operations. To achieve this, we look to communicate effectively with people living and working near our sites and to support local projects and charities.

Supporting local groups and projects

In the last five years, we have provided £92,000 to community projects in the local area via our Landfill Communities Fund (a fund that enables landfill operators to donate part of their annual tax liability to a variety of approved community and environmental projects). In addition to this we have also provided direct support from the quarry. Local events and community projects that have received Tarmac's support recently include:

- Alrewas Village Hall
- Alrewas Cricket Club
- Alrewas Agricultural & Horticultural Society
- The Alrewas Royal British Legion

We are always looking for local groups and projects to support. There are two ways in which people can apply to us for funding:

1. Directly through the quarry: mark.collier@tarmac.com
2. Through the Tarmac Landfill Community Fund. For more information, please visit www.entrust.org.uk or email det@derbyshire.gov.uk

Land donations

We have looked to provide community benefit by donating land that we own or as part of the final restoration of former extraction sites. To date, this has included the site which is now home to The National Memorial Arboretum and the land on which the showground is accommodated. In the event that we secure planning consent for the emerging scheme at Pyford Brook Quarry, we would like to work closely with the community to understand what assets we might be able to provide for the long-term benefit of the community.

Quarry Liaison Group

Since 2014 we have worked closely with our local parish councils and other representatives via our Quarry Liaison Group at Alrewas Quarry. This acts as a forum to ensure that we keep the community updated on our work and to address any questions or concerns. The current site at Pyford Brook also benefits from such a forum. Meetings take place twice a year, and would continue as part of the plans for a proposed new quarry at Pyford Brook.

Did you know?

We permanently donated the ground you are standing on now to the Alrewas and District Agricultural and Horticultural Society so they could host the annual Alrewas Show!

Driving sustainability



Sustainability at Tarmac

We're committed to becoming a Net Zero business by 2050. Decarbonising our operations and providing products, services and solutions that help society and the UK's built environment tackle the climate emergency is central to our strategy and corporate purpose.

Delivering decarbonisation

We've taken early action to drive decarbonisation across our business, including at our sites in Staffordshire. Here are some examples of the sorts of actions we are taking:

- We source all of our electricity from renewable energy sources
- We use less carbon-intensive energy sources where possible; for example, replacing diesel pumps with electric pumps
- We are developing ways of increasing the use of recycled materials when producing asphalt
- We have committed to the transition of our 2,000-strong fleet of corporate cars and vans to electric vehicles (EVs) by 2030
- In a UK first, we are currently trialling an all-electric tipper truck in the Midlands as an alternative to fuelled HGV vehicles
- We already planted more than 19,000 trees in 2022, and are committed to making similar investments in the future

The design of the scheme at Pyford Brook would include measures to increase energy and materials handling efficiency. This would include the use

of an electric ready-mix concrete mixer, which would be completely battery operated. Go and take a look – it's just outside the marquee!

Improving biodiversity

We are also committed to responsible land management and environmental stewardship across all of our sites, and employ site-specific landscape and habitat management plans to support our operations. The same would apply to the new site at Pyford Brook.

One of our main goals is to achieve biodiversity net gain at our sites and contribute to improving national biodiversity. In 2022 alone, we restored over 187 hectares of land across the country. The rest of our operational sites all have carefully designed restoration plans. We also work in partnership with local communities, wildlife trusts and other organisations invested in protecting the environment across the UK.

Case Study – Hints Quarry

We are committed to supporting wildlife and biodiversity across the UK, preserving populations of protected species and enhancing their habitats. One example of this is at Hints Quarry, where we are working together with Cemex to deliver a mosaic of large-scale heathland and acid grassland habitats.